

6. Head replacement

6-1. Removing the head

- (1) Loosen the pan head screw and detach the thermal print head Assy from the upper frame Assy.
- (2) Remove the connector from the thermal print head Assy.

6-2. Installing the head

- (1) Connect the connector.
- (2) Push in the tap of the thermal print head Assy, aligning with the pan head screw (M3) on the upper frame Assy.
- (3) Push in the head of the thermal print head Assy so that the head of the pan head screw can fit in the relief hole for the head of the pan head screw on the upper frame Assy.

Screw tightening torque: 6 kgf.cm

Installing the head is completed.

Note: Forcibly pushing the head may cause the head ground plate to come off.

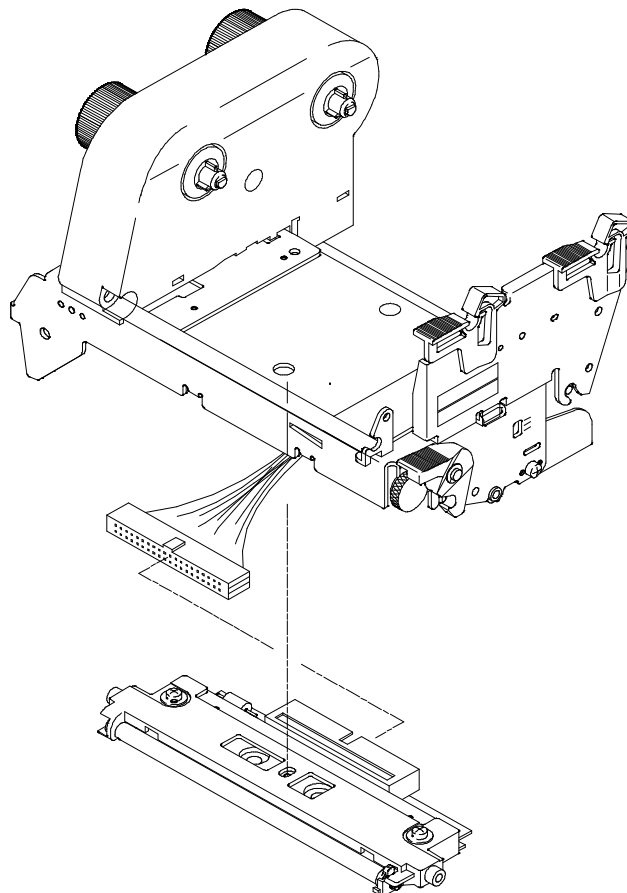

7. Adjustments

7-1. Head offset adjustments

The printer has already been factory-set so that print quality can be obtained when printing on the recommended label paper. When print quality is inferior because of printing on the different paper, adjust it according to the following. Also, adjustments may be needed if print quality is inferior after the head has been replaced.

- (1) Recommended label paper (slick, craft etc) and thermal paper
 - a) Adjust the offset to the center line (center of the three lines) by turning the offset adjust-screw with the screwdriver looking at through the offset verification window.
 - b) Turn two to four the offset adjust-screw counterclockwise. (Factory setting: two turns.)
 - c) Perform test printings and make fine adjustments.

- (2) Thick paper (tag or other similar paper)
 - a) Adjust the offset to the center line (center of the three lines) by turning the offset adjust-screw with the screwdriver looking at through the offset verification window.
 - b) Turn two to four the offset adjust-screw clockwise.
 - c) Perform test printings and make fine adjustments.

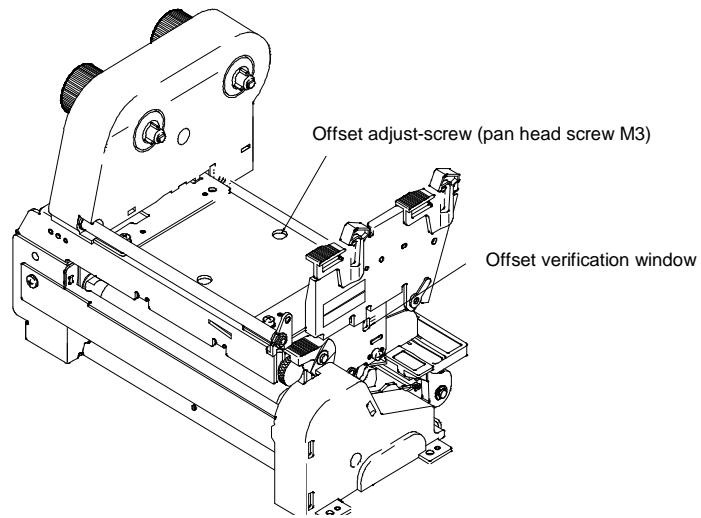

Relationship between offset verification window and heating element is shown as follows:

a: Head position for label

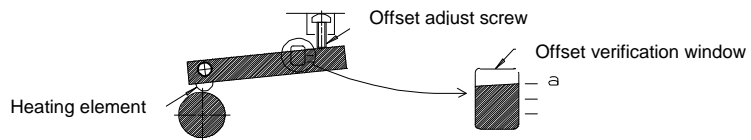

b: Head position for tag

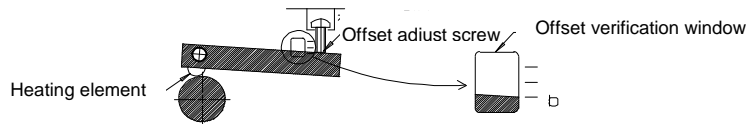

7-2. Head pressure adjustments

The printer has already been factory-set to the paper width of 112 mm. If the paper with a different width is used, make adjustments as follows:

- (1) Adjust the mark (left end of white plastic) to the required width of the paper by turning the head pressure adjust-screw looking at through the head pressure verification window. (Doing this when the head is closed.)
- (2) Perform printings and make fine adjustments.
 - a) When print on the right side is too light:
Move the mark to the right by turning the head pressure adjust-screw clockwise.
 - b) When print on the left side is too light:
Move the mark to the left by turning the head pressure adjust-screw counterclockwise.

These adjustments are useful for avoiding ribbon wrinkle and paper skew.

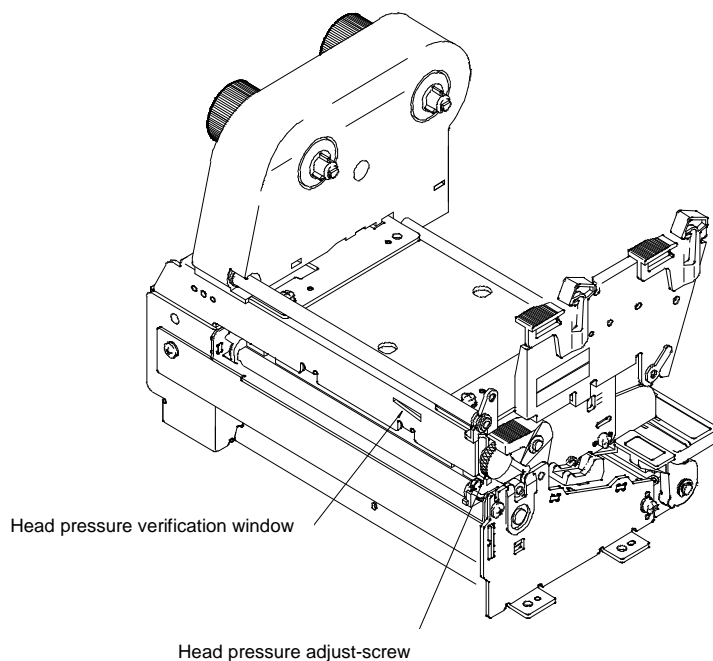

Window	Paper width
	25.4 mm (1 inch)
	50.8 mm (2 inches)
	76.2 mm (3 inches)
	101.6 mm (4 inches)
	Used for adjustment when ribbon wrinkles or skews in paper width of 4 inches
	Factory setting

Note: These values are just for criteria.